

AY2019 Sakura Replanting Project Report

The following is a report of AY2019 Sakura Replanting Project (hereafter referred to as "Project"). The locations of the replanted (i.e., felled and planted) sakura trees (i.e., cherry tree) in AY2019 are illustrated in Appendix 1. "Health degree", which is the diagnosis results by a tree doctor in AY2018, and "explanatory notes for health degree" are also indicated in the lower right corner of Appendix 1.

1. Implementation Report in AY2019

In January 2020, we checked the status of each sakura tree at ICU with an expert in cherry. As for the sakura trees on MacLean Avenue, which are almost 70 years old already, it was judged that their lives can be prolonged as long as the following tasks are carried out: 1) to shape up tree forms by trimming properly; 2) to remove witch's broom disease (a plant disease); 3) to take good care of them with appropriate maintenance.

Nevertheless, as for sakura trees, which need to be replanted due to aging despite much care in every possible way, we will continue to replace them with 6-meter mature trees.

Activity Report in AY2019

- 1) Two sakura trees (No.119 and No.131) were felled and replaced to 6-meter mature trees.
- 2) Two sakura trees (No.121 and No.122) were partly pruned off their branches as essential measures to grow properly.
 - * To improve sakura trees' growing environment such as the sunshine duration, an Aphananthe oriental elm, the adjacent tree to No. 2 sakura tree, was also heavily pruned to the height of the sakura trees nearby.
- 3) Two witch's brooms caused at sakura trees (No. 18 and No. 571) were removed.

As for the replanted sakura trees before AY2018, the year, locations, etc. are illustrated in Appendix 2.

2. Costs in AY2019

The expenses for the Project in AY2019 was **JPY 1,756,700 (including sales tax)**

The details are stated below.

(Unit: JPY)

Activity	Expense (including sales tax)	Note
1) Felling, uprooting, and planting (2 mature trees, 6 meters each)	1,211,100	Including the other costs for changing the soil, removal of surplus soil, haulage, etc.
2) Pruning branches	484,000	Including the costs for heavy pruning of the adjacent Aphananthe oriental elm
3) Removal of witch's brooms	61,600	

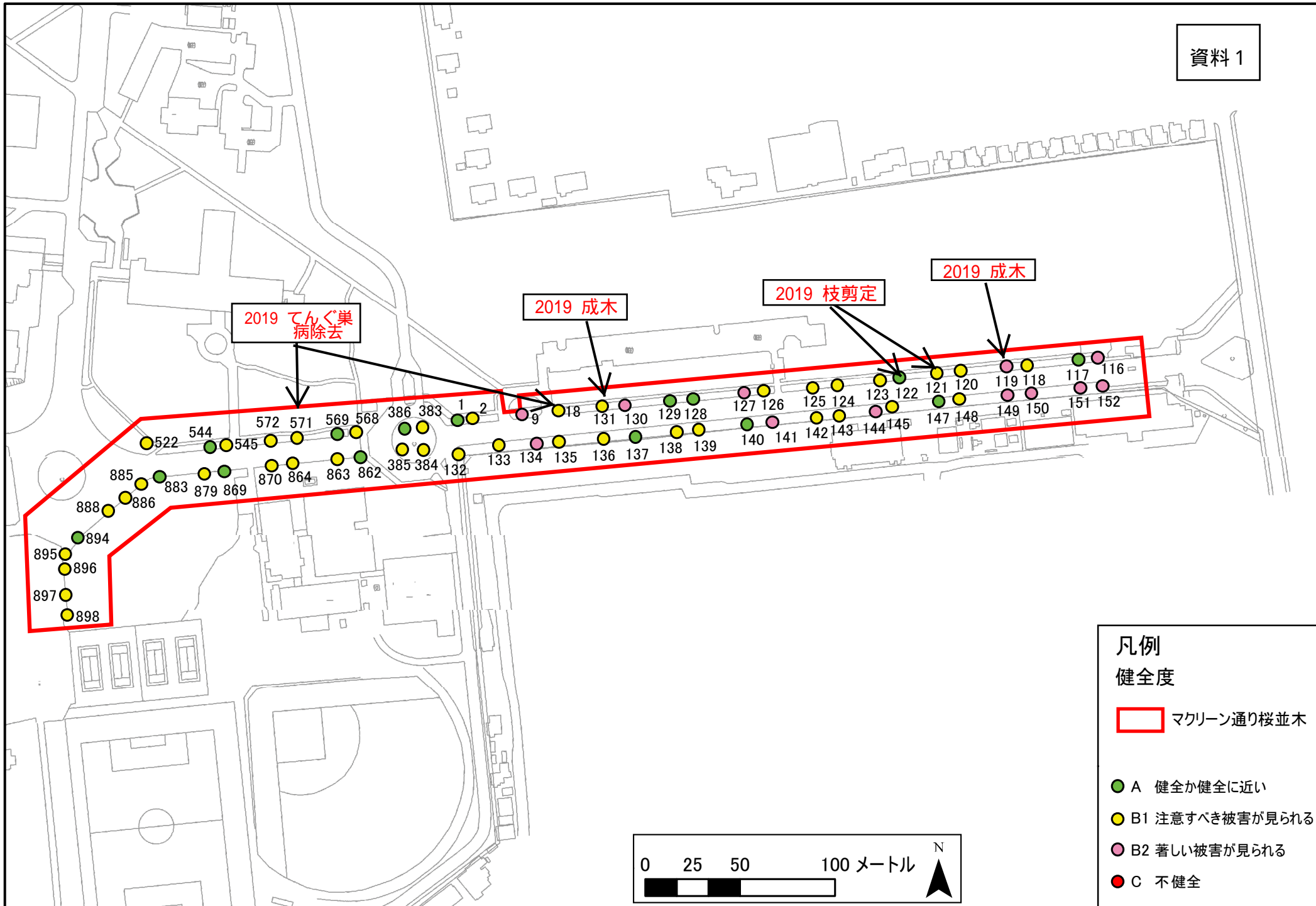

凡例

健全度

マクレーン通り桜並木

- A 健全か健全に近い
- B1 注意すべき被害が見られる
- B2 著しい被害が見られる
- C 不健全

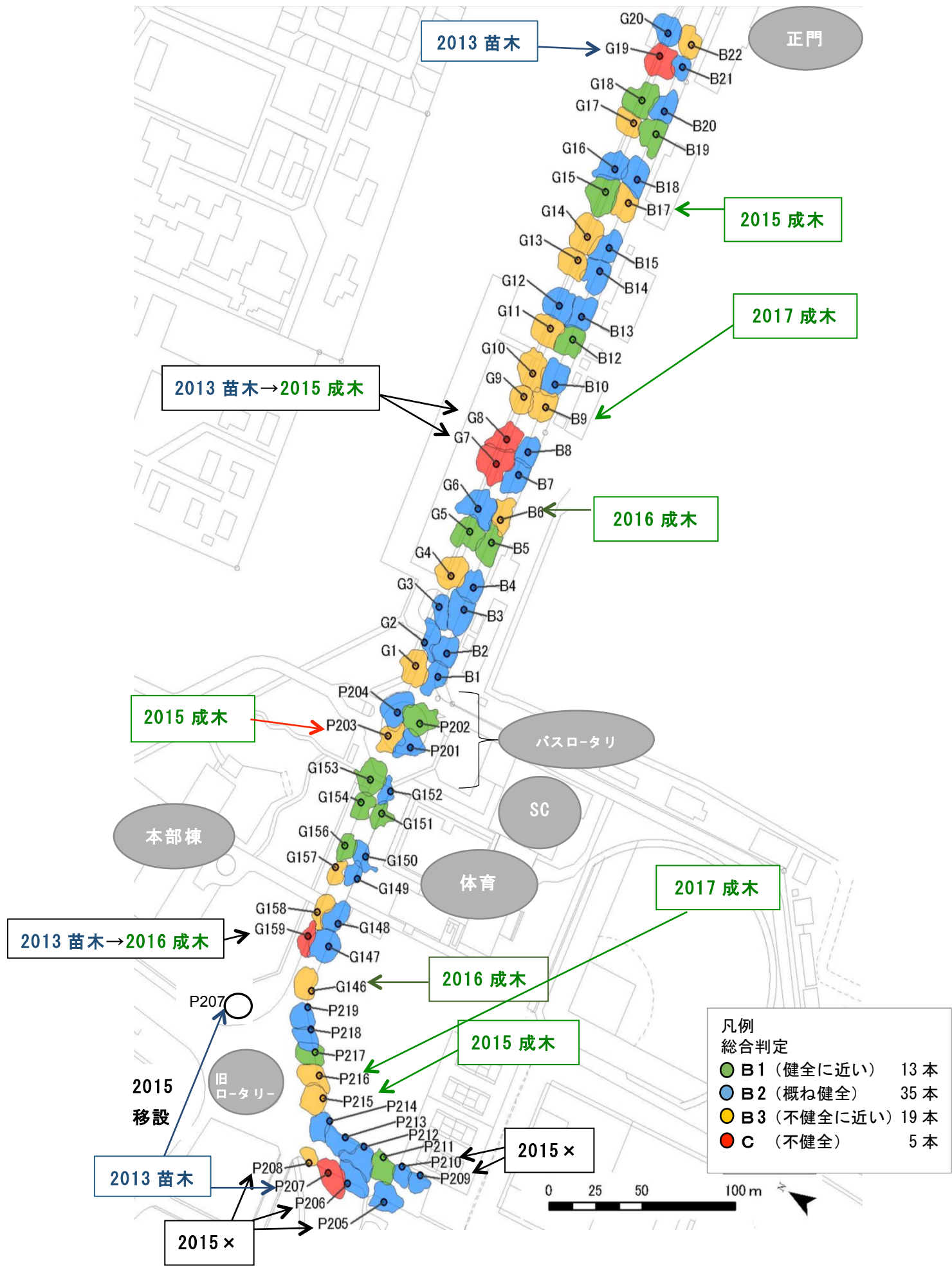

参考：2019年度桜植替え

NO. 1 1 9



NO. 1 3 1



2020年3月25日撮影

